

THIS COPY IS PROVIDED ON A RESTRICTED BASIS AND IS NOT TO BE USED IN ANY WAY DETRIMENTAL TO THE INTERESTS OF PANDUIT CORP.

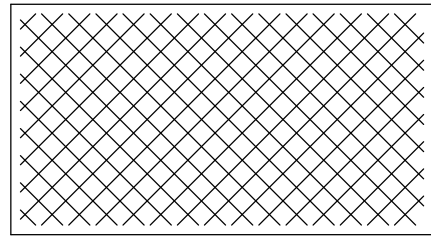

CLEANING PAD (QTY. 1)

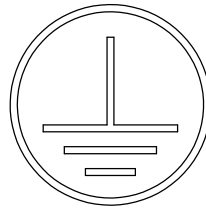

UNIVERSAL GROUNDING STICKER (QTY. 2)



5cc TUBE ANTI-OXIDANT PASTE (QTY. 1)

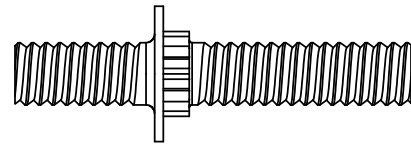

#12-24 THRU-HOLE BONDING STUD (QTY. 8)

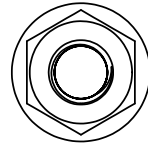

#12-24 BONDING NUT (QTY. 24)

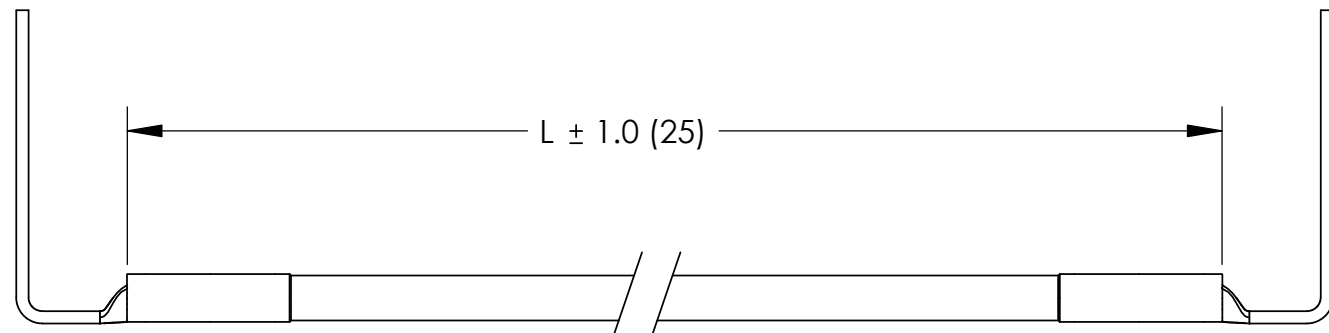

FACTORY CRIMPED #6 AWG FRONT TO BACK RAIL JUMPER GREEN/YELLOW INSULATION (QTY. 2)

PART NUMBER	L
CGJ620UC	20.00 (508)
CGJ630UC	30.00 (762)
CGJ640UC	40.00 (1016)

NOTES:

1. CABINET GROUNDING JUMPER KIT  
PART NUMBERS: CGJ620UC, CGJ630UC, CGJ640UC
2. PACKAGING: 1 KIT PER BAG
3. DIMENSIONS IN PARENTHESIS ARE MILLIMETERS.
4. ALL COMPONENTS THAT MAKE UP THIS KIT ARE RoHS COMPLIANT.



LISTED  
GROUNDING AND BONDING EQUIPMENT



CERTIFIED

C41629\_01

**PANDUIT CORP.** TINLEY PARK, ILLINOIS

FRONT TO BACK RAIL JUMPER KITS  
(CGJ620UC, CGJ630UC, CGJ640UC)  
CUSTOMER DRAWING

UNLESS OTHERWISE SPECIFIED  
DIMENSIONAL TOLERANCES ARE:  
(.X) ±      (.XXX) ±  
(.XX) ±     ANGLES ±

UNLESS OTHERWISE SPECIFIED,  
ALL DIMENSIONS ARE GIVEN IN  
INCHES, THIRD ANGLE PROJECTION

REV	DATE	BY	CHK	DESCRIPTION	ECN	PM	CUST	CHK'D	DRAWN BY	DATE	MAT'L:	SCALE	DRAWING NO / CAD FILE	DWG SIZE
01	3/06	JHNU	JHNU	REVISED DRAWING TITLE	PC00329				JHNU			NONE		
00	1/06	JHNU	JMAR	DRAWING RELEASED	PC00276					1/06			C41629	B SIZE